

d a v i d s t a n c u
p o r t f o l i o

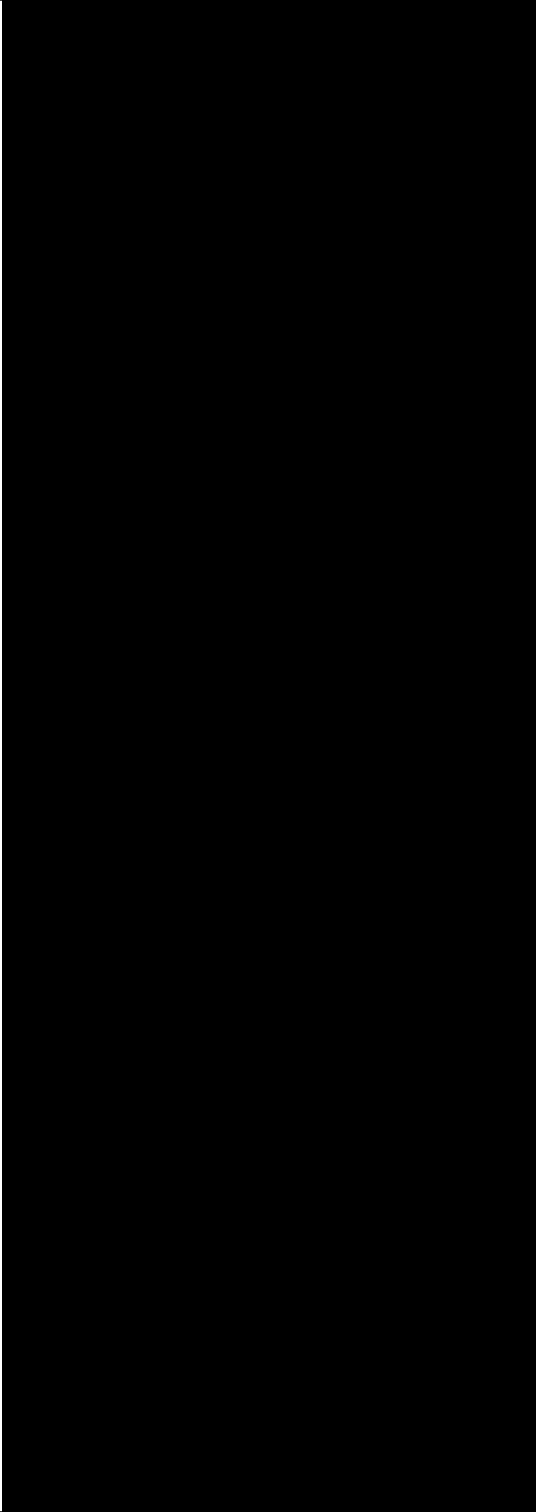

DAVID STANCU

birthday: 8th June 1985
tel. nr.: (+40) 722676005
email: contact@davidstancu.com
website: www.davidstancu.com

Education

University of Architecture and
Urbanism "Ion Mincu", Bucharest,
Romania, 2004-2010

Languages

romanian - native
english - profficient user
french - independent user

Skills

Autodesk Autocad (2D&3D)
Very good (9 years)

3d Studio Max (rendering with v- ray)
Fair (5 years)

Adobe Photoshop
Good (7 years)

CorelDRAW
Good (7 years)

Rhinoceros 3D
Good (4 years)

Sketch-up
Fair (5 years)

Grasshopper plugin for rhino3D
basic (4 years)

Miscellaneous

interest in photography
stechkin.tumblr.com

driver's license for tourisms

Experience

Oct. 2013 - present, Architect, Freelancing ,
March 2012 - Sept. 2013, Architect - Link Future Office Architects Inc., Hangzhou, China
Oct 2010 - Feb 2012, Architect, Zhejiang Suth East Architecture Design Co. Ltd., Hangzhou,
China
Oct - Dec 2009, Junior Architect (internship), Bogoescu Architecture and Urbanism S.R.L.,
Bucharest, Romania
May - Aug 2009, Junior Architect - Kub Architects S.R.L., Bucharest, Romania
Oct 2008 - March 2009, Junior Architect - IDZ Architecture S.R.L., Bucharest, Romania
July 2007 - Oct 2008 and July-Oct 2006, Junior Architect - Studio T S.R.L., Bucharest,
Romania

Competitions

participation, Ciprian Porumbescu urban design competition, Oct 2011, Brasov, Romania
1st prize, national stage, Isover Students' Contest, May 2010, Innsbruck, Austria
1st prize, national stage, Special Presentation prize, international stage, Isover Students'
Contest, April 2009, Ljubljana, Slovenia
participation, National Arts' University's extention competition, Sept 2008, Bucharest,
Romania
participation, Ovidius plaza redesign competition, June 2008, Constanta, Romania
honorable mention, national stage, Isover Students' Contest, June 2008, Dubrovnik,
Croatia

Lectures

Green Drinks Hangzhou, 21.05. 2012, passive house standard presentation, Hangzhou,
China
Summer University, 19-20.07. 2010, Isover Contest's experience, Sibiu, Romania
University of Arhcitecture and Ubrnaism „Ion Mincu“ Colloquium, 03.06.2010, Isover
Contest's experience, Bucharest, Romania
Isover Contest International stage, 15-22.05.2010, Isover Contest's team project,
Innsbruck, Austria
RENEXPO South-East Europe fair, 13.11.2009, Isover Contest's experience, Bucharest,
Romania
Isover Contest International Stage, 21-24.04.2009, Isover Contest's team project,
Ljubljana, Slovenia

Exhibitions and Actions

Stories in Bucharest, photo exhibition, 15th-22nd Jan 2010, Bucharest, Romania
60 wooden churches project, on-site measurements and photo exhibition, July 2009,
Bucharest, Romania
stART Dambovita, public action and exhibition, July-Oct 2007, Bucharest, Romania

Full resume here.

factory&laboratories | hangzhou | china



Our client needed a new factory, laboratories, depositing and offices for its prosthetics products. The area was undeveloped at the time, save for two office towers and a small local governmental office on a nearby plot.

The relatively small plot and green space requirements on the ground forced the solution to stack up and create a more vertical layout.

In order to break the monotony a three-floor section was offsetted thus creating two huge terraces for the offices and meeting floors.

Contribution:

- design concept;
- functional design;
- 3D modelling;
- V-Ray renderings;

Technical data:

Plot area: 9960 sqm;
Building footprint: 2057 sqm;
Building area: 23665.6 sqm;
Included terrace area: 1917 sqm;

Building volume: 97223.7 cm;

Level height G-3rd: 4.8m;
Level height 4th-10th: 4m;

Levels: Ground + 10 levels;

Height: 50m;

@LOA Architects Ltd. 2013



hostel on moon island | dandong | china



The moon island development needed also a budget accomodation unit besides its holiday villas, hotel and art hotel already planned.

The hostel is located next to the main commercial area on the waterfront and acts as a transition between the busy and loud public areas towards the holiday villas.

The shape utilises as much as possible the waterfront by putting two facades towards it.

Also each floor has a number of cut-outs and a common inner courtyard to appeal to the chinese tourists that culturally look for well ventilated and light interiors.

The ground floor houses several small shops and the restaurant as well as several parking spots.



Technical data:

Plot area: 2254.4 sqm;
Footprint: 1016.25 sqm;

Interior built area: 2826,35 sqm;
Terraces&corridors: 1182 sqm;
Usable roof: 1016.25 sqm;

Total built area: 5024.6 mp;
Room capacity: 126 pers.;

Levels: 5;
Level height: 4m;
Total height: 24m;

@LOA Architects Ltd. 2013

Contribution:

- concept design;
- functional design;
- 3D modelling;
- V-Ray rendering;

moon island villa | dandong | china



The client wished for a quiet retreat, both a vacation house and a painting studio, and dandong's moon island on yalu river proved to be a great spot. given its role as a natural border with reclusive north korea, the yalu river is quiet and relaxing.

Given its position and its owner's trade, the villa has to be also a socializing place to hold receptions and parties, which is why the

project has been split into two main parts: one more public area with the main living room, dining room, kitchen, staff rooms, guest rooms and pool, and one private where the main bedroom, children's bedrooms and other living rooms are located. the second floor houses the studio facing the northern steady lights and the main hallway is designed to act as an exhibition space.

Technical data:

Levels: 2 levels;
Underground: 1 level;
Level height: 3.5m;
Total height: 7.5m;

Underground area: 298m²;
Ground floor area: 1267m²;
1st floor area: 672m²;
Total space: 2237m²

@LOA Architects Ltd. 2012

Contribution:

- concept design;
- functional design;
- 3D modelling;
- V-Ray rendering;



hill & water hotel | hangzhou | china



the hangzhou hill and river hotel is an expansion of the similarly named resort located right behind the plot, between the canal and the hill, thus the name.

the project represents the clients' wish to diversify the business and attract more varied types of customers, therefore the

project has a western imagine that, when built, will have the background of hangzhou's preserved forested hills.

the solution consisted in a series of towers for the hotel and possible residences that spring up from a layer of roof gardens, themselves located above a slab of commercial and public functions.

this slab is to create a pedestrian friendly and permeable environment with its courtyards acting as a transition space between the public exterior and the more private interior.

this organizing will help give more privacy and less noise to the rooms located above.

Technical data:

Residential/Hotel level height: 3m;
Residential/Hotel levels: 10 levels;
Commercial level height: 4m;
Commercial levels: 3 levels;

Levels: 13;
Total height: 42m;

Commercial space: 23710m²;
Hotel space: 6422.5m²;
Residential space: 9634.5m²;

Total space: 39767m²

Rooftop gardens: 7099m²;

@LOA Architects Ltd. 2012

Contribution:

- concept design;
- urban design;
- 3D modelling;
- V-Ray rendering;



dian shan hu complex | dian shan hu zhen | china



The Dian Shan Hu masterplan project had two main proposals in order to capitalize as much as possible on both the client and the local administration, as well as the area's opportunities.

The area is located by the DianShan lake in the city with the same name, a popular getaway place for Shanghai people, and is located at the entrance to a loisir area.

The requests were for roughly half of the are to be with holiday residence buildings, while the rest will house offices, shops

and a hotel.

This proposal tries to magnify the effect of the entrance from the NE corner, taking the traveler through stream-line streets and perspectives towards the lake. A row of office buildings separate the residential area from the road to the North, while the hotel is responsible for the main image towards the lake.

The residences are organized on man-made islands, thus bringing the lake atmosphere deeper into the area.

Technical data:

Residence height: 15m;
Residence area: 96360m²;

Public area height: max. 45m;

Public area: 142370m²;

TOTAL: 238730m²;

@LOA Architects Ltd. 2012

Contribution:

- villas' placing;
- urban design;
- additional 3D modelling;
- sketch renderings;

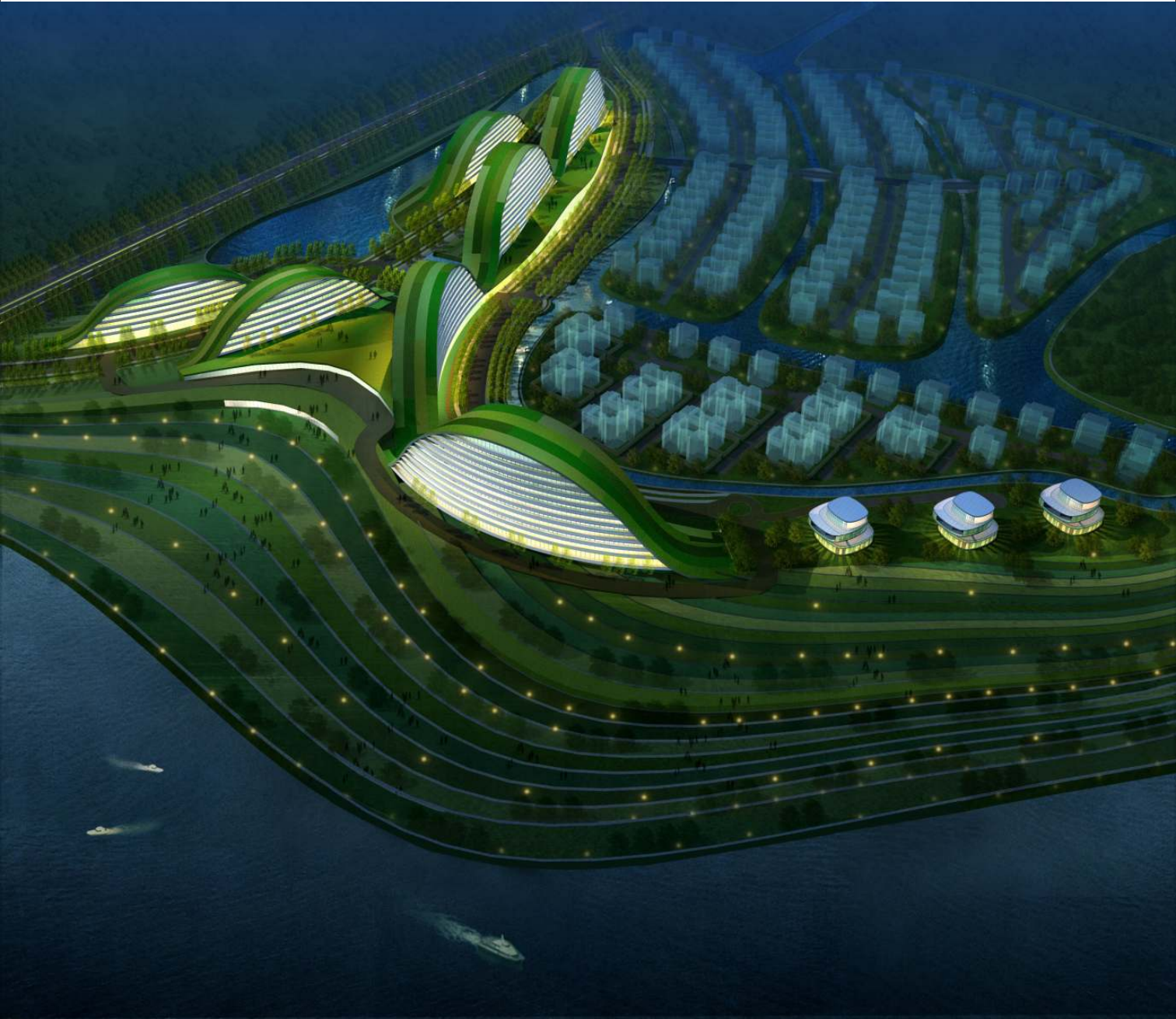

ciprian porumbescu competition | brasov | romania



The OAR competition in Brasov, Romania consisted in revitalising the small area surrounding the statue of romanian composer Ciprian Porumbescu. The statue is located on the corner of a small intersection, in the old part of the town near the entrance to Gheorghe Dima park.

The municipality also wants to create a series of touristic tours across the city, and this spot is at the intersection of two such pathways. One of the tours goes along the city walls, and the other one is

along one of the most circulated tourist streets: Muresenilor str. These two intersect right next to the statue. The competition asked for a way to enhance the statue's visibility and make it important again in the city, while considering the relations with the historical tours and the park.

Our answer was to rise the whole area (150 m2) to a comfortable 40 cm on a wooden deck (with steel structure) in order to separate the space from the street and the park and enhance its

individuality. Also, given its height and wooden furnishings, the fringes of the deck can be used as benches.

At the street-most corner we placed a tall street-light in order to draw attention to the area. This was in conjunction with the historical tour issue for which we also placed an info panel towards the street: information about composer Ciprian Porumbescu and touristic information about the area.

Within the area we proposed two types of urban furniture: a wood + metal bench and waterhole continuing the visual of the streetlight and a “green couch” to be used in summer just opposite of the bench. The bench also has an ON / OFF and volume dials in order to selectively listen to some of the composer’s music.

The statue itself remains untouched, but the base is covered in corten steel in order to individualise it within the project itself and, at the same time evoke the passing of time. Thus, the overall image of the project is a warm, inviting one: wood + corten steel + lawn + grey-coated metal.

We to proposed affordable materials, the overall budget rising up to about 3 of the given 20 000 euros.

Team: Alexandu I. Muntean | Paul Lazar | David Stancu



jinshahu office tower | hangzhou | china



Jin Sha Hu Office tower is part of a larger complex and its main features are the location overlooking the future artificial lake, the proximity to the site's main motorway and the requested metro-station entrance.

The concept was space-folding, meaning the creation of 3D space within the framework of the normal structure, giving a new dimension of office rental. The idea is that each company can buy/rent not only 2D horizontal space but also 3D vertical space. The slabs are partitioned with secondary beams so they can be taken out and staircases can be placed there.

The project features 5 types of floor configuration that can form a multitude of interior spaces by simple juxtaposition. The interior vertical spaces that are created will also allow light inside the building. This will also create the facade composition. The facade itself is double with horizontal glass shades for better light and temperature control.

Technical data:

Height: 100m.

Floors: 25 | 1 underground.

Floor area: 1600 sqm;

Total area: 40000 sqm;

Facade type: double curtain wall + glass shades.

@ZheJiang SouthEast
Architecture Design Co. Ltd.
2011

Contribution:

- concept design;
- functional design;
- urban design;
- 3D modelling;
- presentation Photoshop;

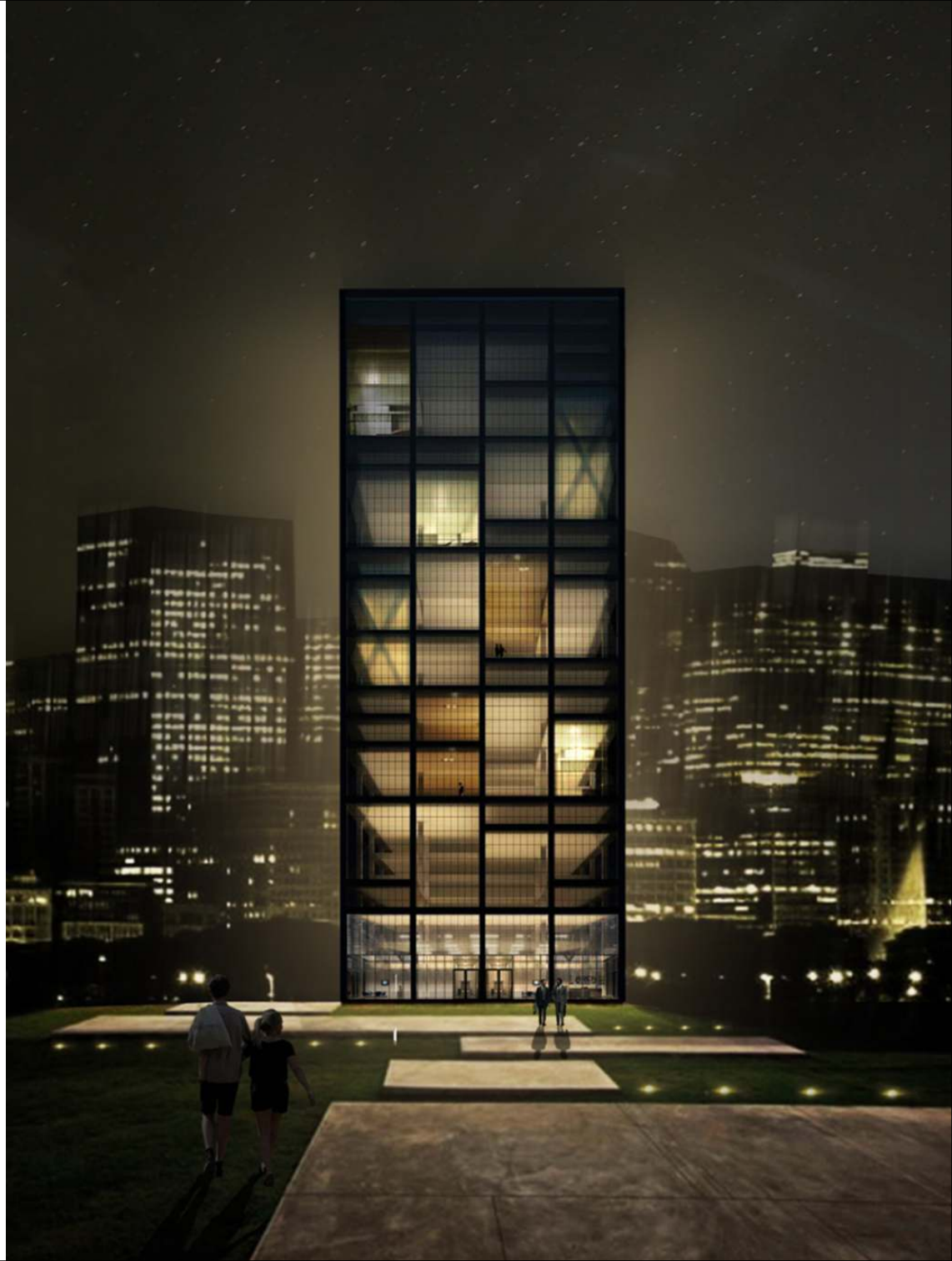



damingshan hotel | shunxizhen | china

Da Ming Shan Hotel project on DaMing mountain, with lake access and ski slopes. This project was done from ground up, the hotel having 80 rooms, restaurant, conference rooms and reception area. The challenge in this project was to use the terrain to our advantage, to rationalise the metallic structure to be able to bring it using the cabin, and usage of local material.

Thus the structural elements have been designed to be no longer than 7m, and local materials were used for the base and containment walls: river stone or simple stone. The facade differentiates the two functions: intimate – hotel (wood/bamboo with white plaster) and public – reception/restaurant (white plaster). In order to avoid overheating by sunlight in summer a sliding panel system with clear glass, sand-blasted glass and wood/bamboo was used in order to obtain a varied and attractive facade compatible with the surrounding areas – steep and forested.

@ZheJiang SouthEast Architecture Design Co. Ltd.
2011

Contribution:

- concept design;
- functional design;
- urban design;
- 3D modelling;
- V-Ray rendering;





The market study, also the diploma project, is situated in the Berceni neighborhood of Bucharest.

Its purpose is to re-organise the existing market into a modern space and time efficient entity able to accommodate both daytime bazaar-type commerce and nighttime bars, while at the same time provide accommodation for the sellers, storage, parking, shops and offices.

Its goals are: better selling environment, provide loisir space, provide green space, provide a refreshing image in the intersection.

The layout is an intermediate type between the traditional layout of the

area, still existing between the communist-era apartment buildings, and the latter. It is composed of irregular Voronoi-generated cells coagulated between three main covered plazas.

These plazas are the main selling areas of the market and also a pedestrian shortcut for the commuter traffic between the bus/tram/metro interchange area of the intersection (north of the site) and several residential areas (west, south-west and south of the site). The overall configuration is based on the introverted layout of the traditional inns that presented an unitary image on the outside and developed an intricate

interior, exacerbated here by the irregular cells.

The overall image is a mix between clear streamline shapes and vertical colored sun shades, thus offering an easy-to-remember shape with much-needed color in the area. The intersection section rises above the ground to act as an entry gate signaling the existence of the building from a distance at the same time providing space for an art exhibition space facing north for even light and looking towards the intersection and the Vacaresti Bvd., an irony towards the dullness of the area and the city itself (traffic).

The building is organized as follows:

- underground: storage, parking and technical rooms;
- ground floor: shops, bars, restaurants, plazas and exhibition center;
- first floor: administration offices, conference room, gardens, hostel and hostel restaurant;
- roof terrace: solar and photovoltaic

panels;

- intersection section: art exhibition centre;

The building is mostly self-sufficient, producing most of its electricity, all its water, heating, and air filtering. Air flow is natural, based upon heating towers and vacuum created by expanding hot air. Fresh air is pre-filtered

in the garden area and then sent into the building, having also a heat-recovery system for winter. The building is also designed to respect the Passive House regulations of less than 15kWh/m² per year energy consumption.

Coordinator: prof. dr. arh. Mihai Opreanu
2010





ISOVER 2010 competition | Paris | France

ISOVER Competition 2010 dealt with the challenge refurbishment creates when also considering Passive House regulations. The 2010 theme was the same for all countries and consisted of refurbishing an old factory in Paris' Pantin district. The site was well placed, next to a canal that divided the area into the industrial north and residential south.

Our concept was to transform this building into a community center, following a long established trend of converting old industrial sites into community-centered entities. Given the proximity of industry we

used as much color as possible, coloring the glass louvres. The whole system is computer-controlled so the louvres (shades) rotate with the sun, providing much needed shade in summer and light in winter, as well as a perpetual-changing facade.

The top terrace is covered by a metal structure sustaining solar panels for both electricity and hot water, while, at the same time, shading the building itself. The north facade is more open with simple white non-movable louvres to let more light in. The site east of the building

was changed into a park thus enhancing its role as a community center.

Our entry for 1st place at the national stage of the competition.

Team: Vladimir Moldovanu | Alexandru Hoffman | David Stancu



tnb refurbishment | bucharest | romania

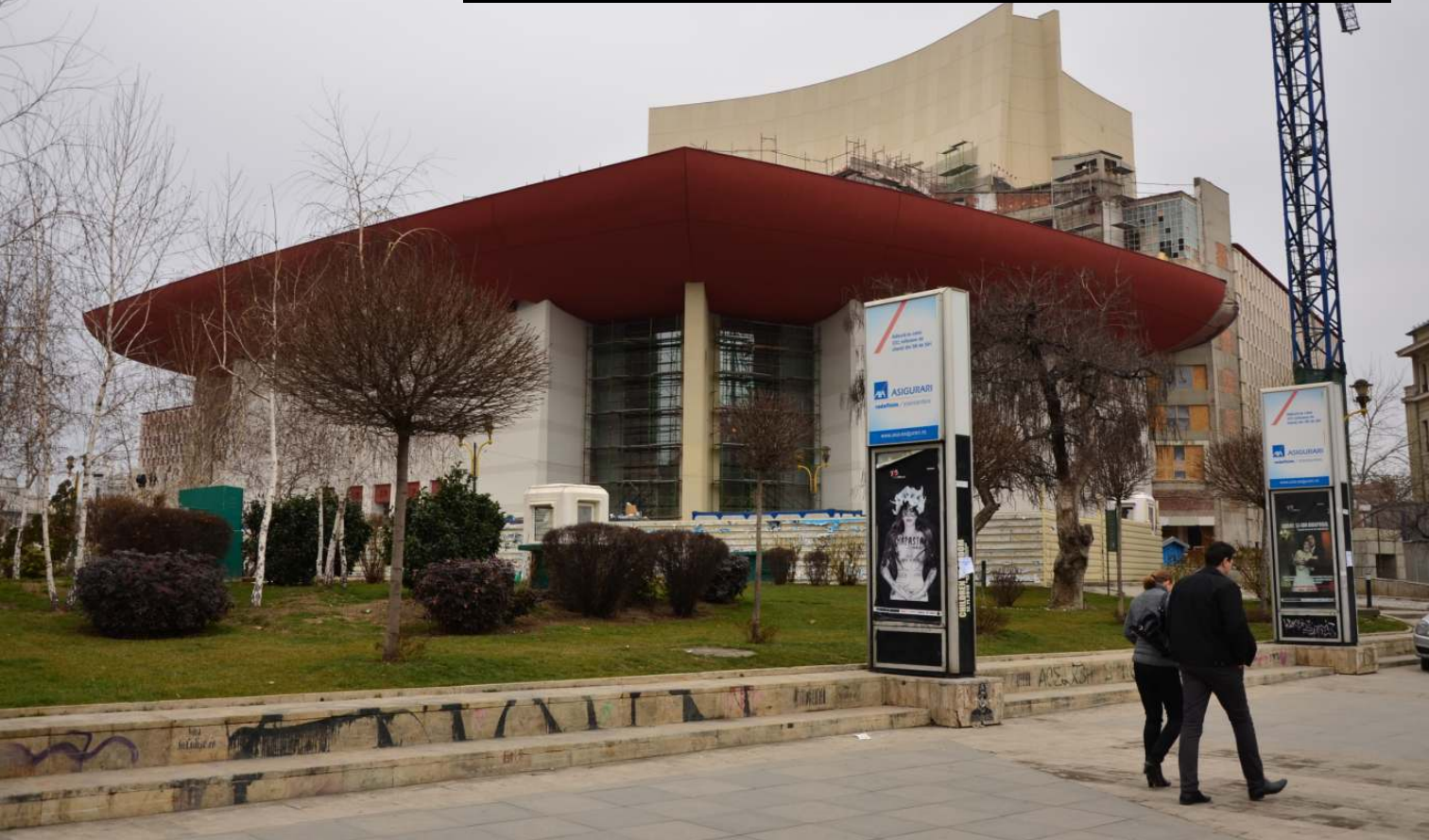

The TNB refurbishment was a more technical experience related to fire-safety regulations and interior re-organising of the National Theatre in Bucharest. For such a big project, the work was broken down between many companies.

The project itself dealt with rolling back the facade to the ante 1980 modifications, internal reorganising, adding more theater rooms, cafes, public spaces, as well as a new library for the employees, open-air theater on the roof, new theater museum and many more minor changes.

Also the existing halls and rooms had to be upgraded to follow the current fire safety regulations. New staircases, elevators and intermediary rooms had to be put in place.

old facade





ISOVER 2009 competition | Bucharest | Romania

ISOVER Competition 2009 was a breakthrough for our design team, taking 1st place at the national level and a Best Presentation mention at the international level.

The theme requested the design of the national office building for ISOVER with Passive House standards. Thus we kept to a compact form, minimising the heat loss, and used the site itself for power-generating, shading and air conditioning. The greenhouses on the facade are used to filter air in summer and humidify the air in winter, acting also as very good "time out" areas. The top terrace has also been used as a garden roof, thus enhancing the "green percent" of the whole site and providing a better insulation for the top level.

Team: Vladimir Moldovanu | Alexandru Hoffman | David Stancu



_night render of exterior terrace arrangement